

Multi Purpose Switch

1 Button



Data Sheet

Features

- Fits standard Australian wall boxes and mounting accessories that use 84mm mounting centres.
- Switch terminals have 4mm bore to suit 1.5mm² cable.
- Soft touch button control.
- Neutral connection not required (2 wire); connect neutral if available (3 wire).
- Auto sensing of 3 wire and 2 wire (no neutral mode).
- LED indicator displays on/off state.
- Covers, plates and buttons are made from UV stabilised polycarbonate to avoid discolouring.
- Silverfish antenna technology.
- Bluetooth mesh connectivity with each device acting as a repeater.
- 2 year warranty.
- Real time energy use in watts & dollars.
- Automatic schedules inbuilt.
- Auto off timer (double press to ignore).
- Power outage recovery.
- Night light on/off and auto dim.
- Multi way switching of other Powermesh devices using Behaviour Link.
- Voice control with your favourite voice assistant.*

Plus more features with the latest software version. Visit www.zimi.life

Specifications

Product Code	Colour	Description
PMMP51	White	Powermesh Multi Purpose Switch 1 Button
PMMP51BK	Black	

- **Motor Rating:** M40
- **3 wire with Neutral:** 240V~ 5AX maximum
- **2 wire without Neutral:** 240V~ 5A maximum for channel one, suitable load required.

Always use a Neutral wire where possible. When operating without a neutral connected, a small amount of power is used via LOAD 1 when switched off. This may in some instances result with lights not completely turning off. **Dimmable** loads might be fixed by increasing to at least 2 lights with a load >10W. **Non-Dimmable** loads may require a bypass/load correction device fitted if the load is insufficient.

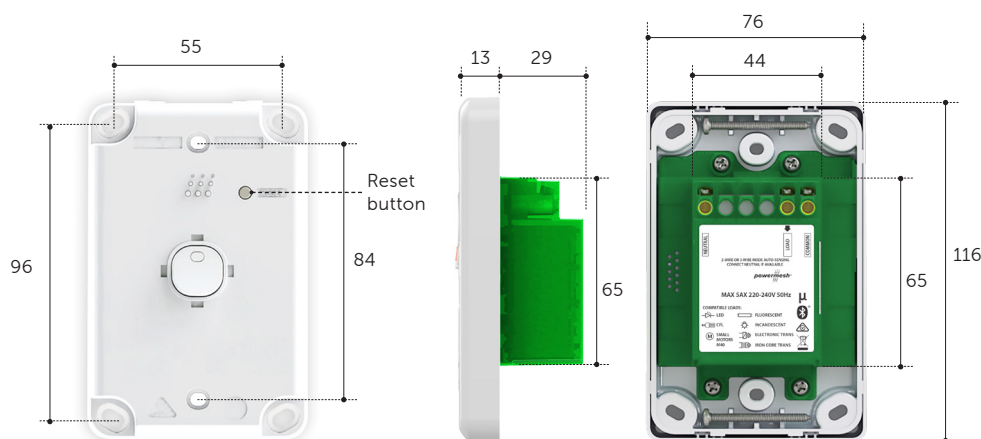

Dimensions in mm

Compatible load types*

LED	Electronic transformers
Incandescent	Standard iron core & toroidal transformers
Fluorescent	Exhaust fans small motors
CFLs	

Cleaning Guidelines

Ensure that switches are turned off before cleaning. Only clean the surfaces with a damp or dry cloth.

DO NOT

- x spray anything directly on to electrical switches or power point sockets
- x use cleaning sprays or harsh chemical cleaners
- x use an abrasive cloth
- x wash the cover plates in hot water.



PMMP51

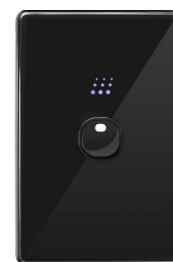

PMMP51BK

Standards Approval:

AS/NZ60669.2.1 & AS/NZS CISPR15

Certification Number:

GMA-506936-EA



Download Zimi

Scan the code with your phone camera to download.



Zimi Cloud Connect *

Control all your Powermesh devices anywhere in the world via your Wi-Fi Internet.



zimi 14 Millennium Circuit, Helensvale, QLD 4212 Australia. www.zimi.life

Need help?
<https://support.zimi.life>

Powermesh products must be installed by a qualified electrician. Zimi requires a compatible (Android, iOS) mobile device, minimum OS requirements are available at www.zimi.life. Availability and performance of certain features are service, device and network-dependent and may not be available in all areas; subscription(s) may be required, and additional terms, conditions and/or charges may apply. All features, functionality and other product specifications are subject to change without notice or obligation. Powermesh products are optimised for the use with the Zimi App. The Bluetooth word mark and logos are registered trademarks owned by the Bluetooth SIG, Inc. iOS is a trademark or registered trademark of Cisco Inc. Zimi and Powermesh and their respective logos are registered trademarks of Zimi Ltd. Google and Google Play are trademarks of Google LLC. Amazon, Alexa, and all related logos are trademarks of Amazon.com, Inc. or its affiliates. Apple, the Apple logo, Apple Watch and iPhone are trademarks of Apple Inc., registered in the U.S. and other countries. App Store is a service mark of Apple Inc., registered in the U.S. and other countries. Copyright © 2021 Zimi Ltd. All rights reserved.

Multi Purpose Switch

2 Button



Data Sheet

Features

- Fits standard Australian wall boxes and mounting accessories that use 84mm mounting centres.
- Switch terminals have 4mm bore to suit 1.5mm² cable.
- Soft touch button control.
- Neutral connection not required (2 wire); connect neutral if available (3 wire).
- Auto sensing of 3 wire and 2 wire (no neutral mode).
- LED indicator displays on/off state.
- Covers, plates and buttons are made from UV stabilised polycarbonate to avoid discolouring.
- Silverfish antenna technology.
- Bluetooth mesh connectivity with each device acting as a repeater.
- 2 year warranty.
- Real time energy use in watts & dollars.
- Automatic schedules inbuilt.
- Auto off timer (double press to ignore).
- Power outage recovery.
- Night light on/off and auto dim.
- Multi way switching of other Powermesh devices using Behaviour Link.
- Voice control with your favourite voice assistant.*

Plus more features with the latest software version. Visit www.zimi.life

Specifications

Product Code	Colour	Description
PMMP52	White	Powermesh Multi Purpose Switch
PMMP52BK	Black	2 Button

- **Motor Rating:** M40
- **3 wire with Neutral:** 240V~ 5AX max per channel, 10AX total max load.
- **2 wire without Neutral:** 240V~ 5AX max per channel, channel 1 is 5A only.

Always use a Neutral wire where possible. When operating without a neutral connected, a small amount of power is used via LOAD 1 when switched off. This may in some instances result with lights not completely turning off. **Dimmable** loads might be fixed by increasing to at least 2 lights with a load >10W. **Non-Dimmable** loads may require a bypass/load correction device fitted if the load is insufficient.

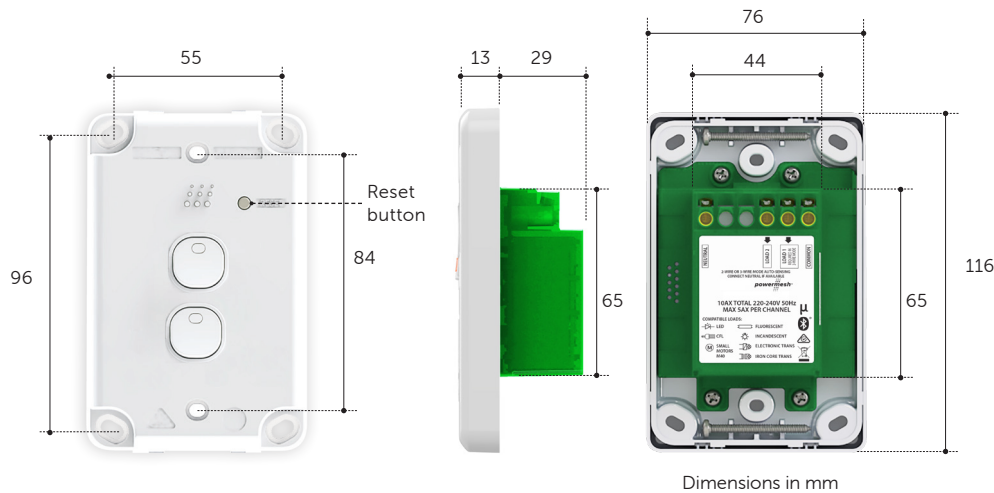

Compatible load types*

	LED		Electronic transformers
	Incandescent		Standard iron core & toroidal transformers
	Fluorescent		Exhaust fans small motors
	CFLs		

Cleaning Guidelines

Ensure that switches are turned off before cleaning. Only clean the surfaces with a damp or dry cloth.

DO NOT

- x spray anything directly on to electrical switches or power point sockets
- x use cleaning sprays or harsh chemical cleaners
- x use an abrasive cloth
- x wash the cover plates in hot water.



PMMP52



PMMP52BK

Standards Approval:

AS/NZ60669.2.1 & AS/NZS CISPR15

Certification Number:

GMA-506936-EA



Download Zimi

Scan the code with your phone camera to download.



Zimi Cloud Connect *

Control all your Powermesh devices anywhere in the world via your Wi-Fi Internet.



zimi 14 Millennium Circuit, Helensvale, QLD 4212 Australia. www.zimi.life

Need help?
<https://support.zimi.life>

Powermesh products must be installed by a qualified electrician. Zimi requires a compatible (Android, iOS) mobile device, minimum OS requirements are available at www.zimi.life. Availability and performance of certain features are service, device and network-dependent and may not be available in all areas; subscription(s) may be required, and additional terms, conditions and/or charges may apply. All features, functionality and other product specifications are subject to change without notice or obligation. Powermesh products are optimised for the use with the Zimi App. The Bluetooth word mark and logos are registered trademarks owned by the Bluetooth SIG, Inc. iOS is a trademark or registered trademark of Cisco Inc. Zimi and Powermesh and their respective logos are registered trademarks of Zimi Ltd. Google and Google Play are trademarks of Google LLC. Amazon, Alexa, and all related logos are trademarks of Amazon.com, Inc. or its affiliates. Apple, the Apple logo, Apple Watch and iPhone are trademarks of Apple Inc., registered in the U.S. and other countries. App Store is a service mark of Apple Inc., registered in the U.S. and other countries. Copyright © 2021 Zimi Ltd. All rights reserved.

Multi Purpose Switch

3 Button



Data Sheet

Features

- Fits standard Australian wall boxes and mounting accessories that use 84mm mounting centres.
- Switch terminals have 4mm bore to suit 1.5mm² cable.
- Soft touch button control.
- Neutral connection not required (2 wire); connect neutral if available (3 wire).
- Auto sensing of 3 wire and 2 wire (no neutral mode).
- LED indicator displays on/off state.
- Covers, plates and buttons are made from UV stabilised polycarbonate to avoid discolouring.
- Silverfish antenna technology.
- Bluetooth mesh connectivity with each device acting as a repeater.
- 2 year warranty.
- Real time energy use in watts & dollars.
- Automatic schedules inbuilt.
- Auto off timer (double press to ignore).
- Power outage recovery.
- Night light on/off and auto dim.
- Multi way switching of other Powermesh devices using Behaviour Link.
- Voice control with your favourite voice assistant.*

Plus more features with the latest software version. Visit www.zimi.life

Specifications

Product Code	Colour	Description
PMMP3	White	Powermesh Multi Purpose Switch
PMMP3BK	Black	3 Button

- **Motor Rating:** M40
- **3 wire with Neutral:** 240V~ 5AX max per channel, 10AX max load.
- **2 wire without Neutral:** 240V~ 5AX max per channel, channel 1 is 5A only.

Always use a Neutral wire where possible. When operating without a neutral connected, a small amount of power is used via LOAD 1 when switched off. This may in some instances result with lights not completely turning off. **Dimmable** loads might be fixed by increasing to at least 2 lights with a load >10W. **Non-Dimmable** loads may require a bypass/load correction device fitted if the load is insufficient.

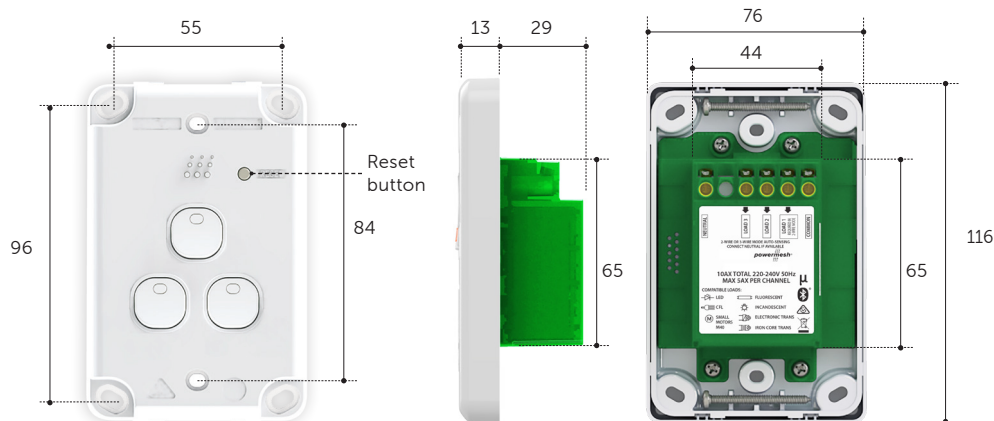

Dimensions in mm

Compatible load types*

	LED		Electronic transformers
	Incandescent		Standard iron core & toroidal transformers
	Fluorescent		Exhaust fans small motors
	CFLs		

Cleaning Guidelines

Ensure that switches are turned off before cleaning. Only clean the surfaces with a damp or dry cloth.

DO NOT

- x spray anything directly on to electrical switches or power point sockets
- x use cleaning sprays or harsh chemical cleaners
- x use an abrasive cloth
- x wash the cover plates in hot water.



PMMP3



PMMP3BK

Standards Approval:

AS/NZ60669.2.1 & AS/NZS CISPR15

Certification Number:

GMA-506939-EA



Download Zimi

Scan the code with your phone camera to download.



Zimi Cloud Connect *

Control all your Powermesh devices anywhere in the world via your Wi-Fi Internet.



zimi 14 Millennium Circuit, Helensvale, QLD 4212 Australia. www.zimi.life

Need help?
<https://support.zimi.life>

Powermesh products must be installed by a qualified electrician. Zimi requires a compatible (Android, iOS) mobile device, minimum OS requirements are available at www.zimi.life. Availability and performance of certain features are service, device and network-dependent and may not be available in all areas; subscription(s) may be required, and additional terms, conditions and/or charges may apply. All features, functionality and other product specifications are subject to change without notice or obligation. Powermesh products are optimised for the use with the Zimi App. The Bluetooth word mark and logos are registered trademarks owned by the Bluetooth SIG, Inc. iOS is a trademark or registered trademark of Cisco Inc. Zimi and Powermesh and their respective logos are registered trademarks of Zimi Ltd. Google and Google Play are trademarks of Google LLC. Amazon, Alexa, and all related logos are trademarks of Amazon.com, Inc. or its affiliates. Apple, the Apple logo, Apple Watch and iPhone are trademarks of Apple Inc., registered in the U.S. and other countries. App Store is a service mark of Apple Inc., registered in the U.S. and other countries. Copyright © 2021 Zimi Ltd. All rights reserved.

Multi Purpose Switch

4 Button



Data Sheet

Features

- Fits standard Australian wall boxes and mounting accessories that use 84mm mounting centres.
- Switch terminals have 4mm bore to suit 1.5mm² cable.
- Soft touch button control.
- Neutral connection not required (2 wire); connect neutral if available (3 wire).
- Auto sensing of 3 wire and 2 wire (no neutral mode).
- LED indicator displays on/off state.
- Covers, plates and buttons are made from UV stabilised polycarbonate to avoid discolouring.
- Silverfish antenna technology.
- 2 year warranty.
- Bluetooth mesh connectivity with each device acting as a repeater.
- Real time energy use in watts & dollars.
- Automatic schedules inbuilt.
- Auto off timer (double press to ignore).
- Power outage recovery.
- Night light on/off and auto dim.
- Multi way switching of other Powermesh devices using Behaviour Link.
- Voice control with your favourite voice assistant.*

Plus more features with the latest software version. Visit www.zimi.life

Specifications

Product Code	Colour	Description
PMMP54	White	Powermesh Multi Purpose Switch
PMMP54BK	Black	4 Button

- **Motor Rating:** M40
- **3 wire with Neutral:** 240V~ 5AX max per channel, 10AX max load.
- **2 wire without Neutral:** 240V~ 5AX max per channel, channel 1 is 5A only.

Always use a Neutral wire where possible. When operating without a neutral connected, a small amount of power is used via LOAD 1 when switched off. This may in some instances result with lights not completely turning off. **Dimmable** loads might be fixed by increasing to at least 2 lights with a load >10W. **Non-Dimmable** loads may require a bypass/load correction device fitted if the load is insufficient.

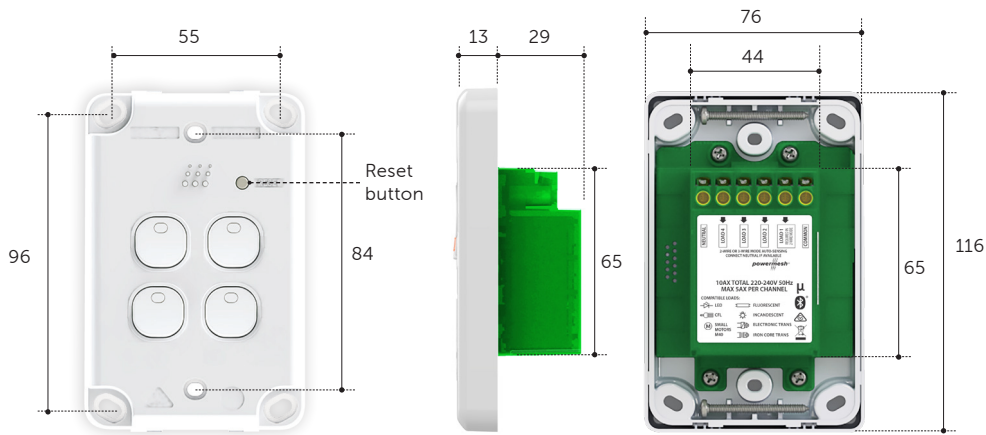

Dimensions in mm

Compatible load types*

LED	Electronic transformers
Incandescent	Standard iron core & toroidal transformers
Fluorescent	Exhaust fans small motors
CFLs	

Cleaning Guidelines

Ensure that switches are turned off before cleaning. Only clean the surfaces with a damp or dry cloth.

DO NOT

- x spray anything directly on to electrical switches or power point sockets
- x use cleaning sprays or harsh chemical cleaners
- x use an abrasive cloth
- x wash the cover plates in hot water.



PMMP54



PMMP54BK

Standards Approval:

AS/NZ60669.2.1 & AS/NZS CISPR15

Certification Number:

GMA-506939-EA



Download Zimi

Scan the code with your phone camera to download.



Zimi Cloud Connect *

Control all your Powermesh devices anywhere in the world via your Wi-Fi Internet.



zimi 14 Millennium Circuit, Helensvale, QLD 4212 Australia. www.zimi.life

Need help?
<https://support.zimi.life>

Powermesh products must be installed by a qualified electrician. Zimi requires a compatible (Android, iOS) mobile device, minimum OS requirements are available at www.zimi.life. Availability and performance of certain features are service, device and network-dependent and may not be available in all areas; subscription(s) may be required, and additional terms, conditions and/or charges may apply. All features, functionality and other product specifications are subject to change without notice or obligation. Powermesh products are optimised for the use with the Zimi App. The Bluetooth word mark and logos are registered trademarks owned by the Bluetooth SIG, Inc. iOS is a trademark or registered trademark of Cisco Inc. Zimi and Powermesh and their respective logos are registered trademarks of Zimi Ltd. Google and Google Play are trademarks of Google LLC. Amazon, Alexa, and all related logos are trademarks of Amazon.com, Inc. or its affiliates. Apple, the Apple logo, Apple Watch and iPhone are trademarks of Apple Inc., registered in the U.S. and other countries. App Store is a service mark of Apple Inc., registered in the U.S. and other countries. Copyright © 2021 Zimi Ltd. All rights reserved.